

Testa angolare con flangia

NIKKEN

Montata direttamente
sul mandrino macchina

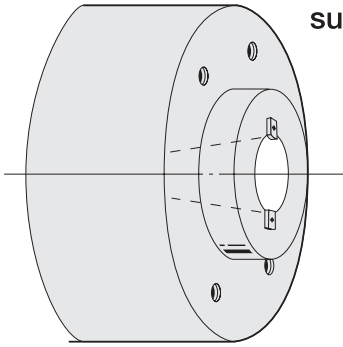

Mandrino macchina

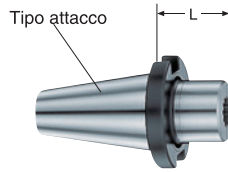

Attacco per flangia

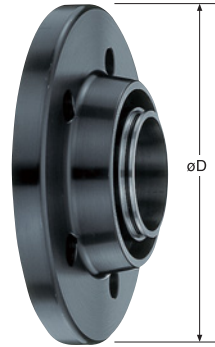

Flangia



Testa modulare

NT 50 - F 235 - 14

Attacco • øD • L

F 235 - AHM

• ø esterno flangia • Testa angolare modulare • Tipo di flangia

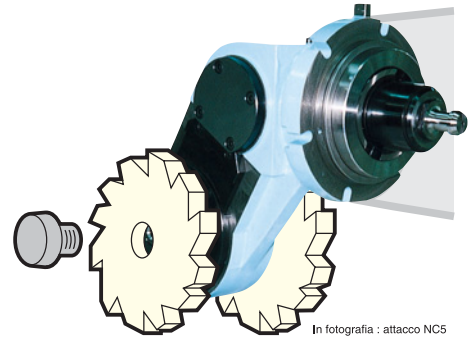
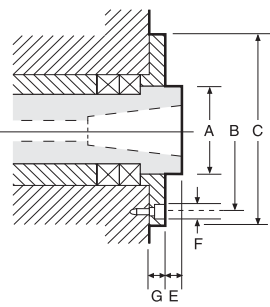
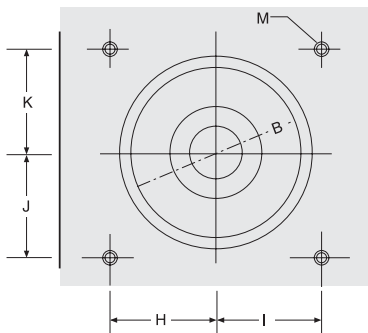

In fotografia : attacco NC5

* Vi preghiamo in caso di ordine, di precisare sempre le quote :
A, B, C, D, E, F, G, H, I, J, K, L, M. Per maggiore comprensibilità
è utile farci avere anche il disegno del pezzo da lavorare.

Informazioni sul perno di posizionamento

NIKKEN

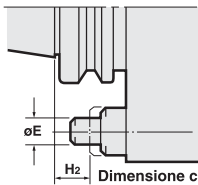

Fig.1

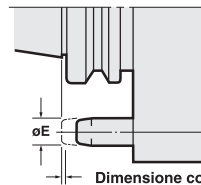
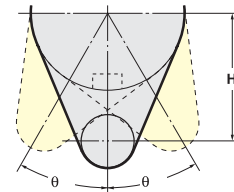

Fig.2



In base alla vostra macchina aggiustare la quota H.

Costruttore macchina	Attacco	H	E	H2	Fig.
ENSHU	BT30	50	12	4	1
	40	60	12	14	1
	50	82	18	22	1
OKUMA	BT40	65	18	0	2
	50	80	18	0	2
OKUMA & HOWA	BT40	65	18	0	2
	50	80	18	11	2
OKK	BT40	65	12	16	1
	50	82	18	22	1
KITAMURA	BT40	65	18	0	2
	50	82	18	22	1
KURASHIKI	BT40	60	12	14	1
	50	145	18	0	2
SHIN NIPPON KOKI	BT50	82	18	22	1
	BT40	65	18	0	2
TOSHIBA	50	145	24	24	2
	BT40	65	18	0	2
TOYODA	50	80	18	4	2
	BT40	65	18	0	2
NIIGATA	BT40	65	18	0	2
	50	80	18	11	2

Costruttore macchina	Attacco	H	E	H2	Fig.
HITACHI SEIKI	BT40	60	12	14	1
	50	82	18	22	1
BROTHER	BT30	40	12	12	1
	40	60	12	14	1
KIRA	BT30	55	12	-1	1
FANUC	BT30	55	12	29	1
	BT40	65	18	2	2
MAKINO	50	80	18	5	2
	BT40	60	12	28	1
MATSUURA	50	82	18	22	1
	BT40	60	12	14	1
MITSUI SEIKI	50	82	18	22	1
	BT40	65	18	0	2
MITSUBISI	50	80	18	27.7	2
	BT40	65	18	4	2
MORI SEIKI	50	80	18	0	2
	BT40	65	18	2	2
YAMAZAKI MAZAK	50	80	18	0	2
	BT40	62	18	9	2
ROKU-ROKU	BT40	60	12	14	1
YASUDA	BT40	60	12	14	1
	50	82	18	22	1

VARIE

Recessitore automatico

NIKKEN

AF

Non c'è incollamento truciolo. Meccanismo automatico di apertura/chiusura lama. Non serve blocchetto di posizionamento.

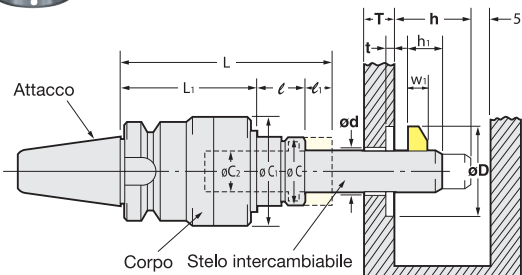
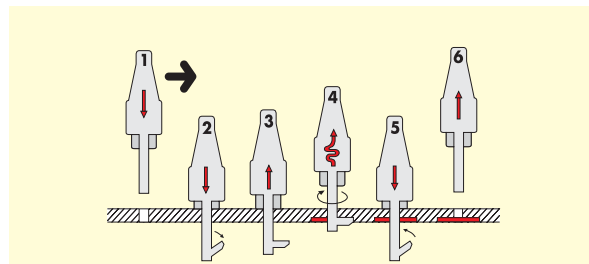

Steli intercambiabili per le diverse operazioni.

- La dimensione l_1 indica la lunghezza minima del tagliente perchè possa rientrare nella sede dopo aver lavorato.
- In caso di ordine, indicare sempre le quote $\odot d$, $\odot D$, T, t e h e il materiale da lavorare.
- Sono disponibili anche utensili in metallo duro saldobrasato.

CONO	ARTICOLO	d	D	L	L ₁	l	l ₁	C	C ₁	C ₂	Peso (kg)	Articolo steli
		MIN.	MAX.									
No.40	BT40-AF1-20	16	32	185	143	7	35	60	90	32	4.5	BF120-dxDxT
	(IT40) -30	29	58	205	153		45				4.8	BF130-dxDxT
	-40	40	80	225	163		55				5.0	BF140-dxDxT
No.50	BT50-AF1-20	16	32	160	118	7	35	60	90	32	6.0	BF120-dxDxT
	(IT50) -30	29	58	180	128		45				6.5	BF130-dxDxT
	-40	40	80	200	138		55				7.0	BF140-dxDxT
	BT50-AF2-50	50	90	230	158	7	65	73	112	40	9.0	BF250-dxDxT
	(IT50) -60	60	100	250	168		75				9.5	BF260-dxDxT
	-70	70	130	270	178		85				10.0	BF270-dxDxT

BF Steli intercambiabili per recessore automatico

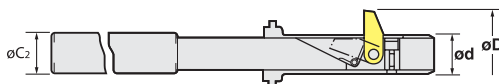

Spiegazione dell'articolo

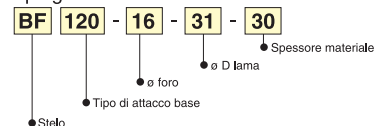

Steli intercambiabili ART.	øD	ød	T	h ₁	h	C ₂	W ₁ -W ₂ lama	Corpo base ART.
BF120-d-D-T	18~ 32	15.8~ 17.7	Standard	32	63	32	8 x 4	BT40, 50-AF1-20
BF120-d-D-T	20~ 36	17.8~ 19.9		30	65		10 x 6	
BF120-d-D-T	23~ 40	20~ 22.4		35	68		10 x 8	
BF120-d-D-T	26~ 45	22.5~ 25.9		73	83		12 x 8	
BF120-d-D-T	29~ 50	26~ 28.9		73	83		15 x 10	
BF120-d-D-T	32~ 50	29~ 31.9		73	83			
BF130-d-D-T	51~ 58	32~ 35.9		73	83		15 x 12	
BF120-d-D-T	36~ 55	32~ 35.9		73	83			
BF130-d-D-T	56~ 63	36~ 39.9		79	89		18 x 15	
BF120-d-D-T	40~ 55	36~ 39.9		79	89			
BF130-d-D-T	56~ 73	36~ 39.9		79	89		18 x 15	
BF120-d-D-T	45~ 60	40~ 44.9		99	99			
BF130-d-D-T	61~ 75	40~ 44.9	99	99	20 x 15			
BF140-d-D-T	76~ 80	40~ 44.9	99	99				
BF120-d-D-T	50~ 60	45~ 49.9	65	109	18 x 15			
BF130-d-D-T	61~ 75	45~ 49.9	70	119				
BF140-d-D-T	76~ 80	45~ 49.9	75	129	20 x 15			
BF250-d-D-T	75~ 85	50~ 54.9	65	111				
BF260-d-D-T	85~ 95	50~ 54.9	70	121	20 x 15			
BF270-d-D-T	90~ 100	50~ 54.9	75	131				
BF250-d-D-T	85~ 95	55~ 61.9	65	111	22 x 18			
BF260-d-D-T	95~ 105	55~ 61.9	70	121				
BF270-d-D-T	100~ 110	55~ 61.9	75	131	22 x 18			
BF250-d-D-T	95~ 105	62~ 69.9	65	118				
BF260-d-D-T	105~ 115	62~ 69.9	70	121	22 x 18			
BF270-d-D-T	110~ 120	62~ 69.9	75	138				
BF250-d-D-T	105~ 115	70~ 74.9	65	118	22 x 18			
BF260-d-D-T	115~ 125	70~ 74.9	70	121				
BF270-d-D-T	120~ 130	70~ 74.9	75	138	22 x 18			

*L'ordine minimo per le lame è di 5 pz.

VARIE